

#28-966 / #28-967 / #28-968
 #28-969 / #28-970 / #28-971

Landscape Wheelbarrows

Double Wheel - 8 cu. ft.

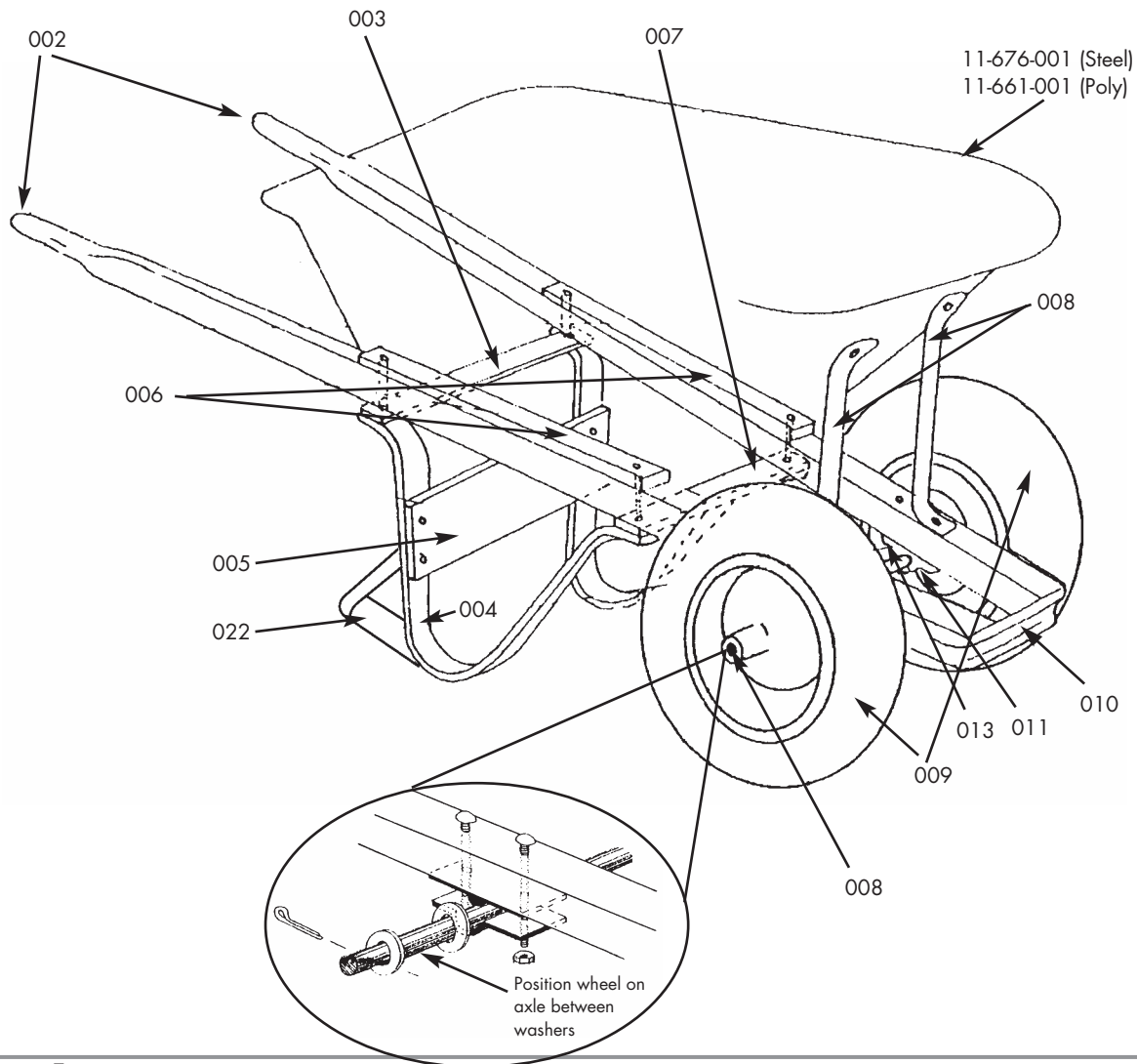

Parts List

Ref #	Key #	Part #	Detail	Qty/Unit	Ref #	Key #	Part #	Detail	Qty/Unit
28-966	001	50-197	Poly Tray	1	28-966	011	50-247	24" Axle	1
28-966	002	50-532	Sreel Handles (pr)	1	28-966	013	50-332	Axle Bracket (Dbl Wheel Only)	2
28-966	002	50-244	Wood Handles (pr)	1	28-966	n/a	52-435	Carriage Bolt $\frac{5}{16}$ " x 5"	2
28-966	003	50-319	Rear Support	1	28-966	n/a	52-434	Carriage Bolt $\frac{5}{16}$ " x 3 $\frac{3}{4}$ "	2
28-966	004	50-320	Leg	2	28-966	n/a	52-433	Carriage Bolt $\frac{5}{16}$ " x 2 $\frac{1}{2}$ "	4
28-966	005	50-321	Leg Brace	1	28-966	n/a	52-401	Carriage Bolt $\frac{5}{16}$ " x 2 $\frac{1}{4}$ "	4
28-966	006	50-323	Wedge	2	28-966	n/a	52-438	Carriage Bolt $\frac{5}{16}$ " x 1"	8
28-966	007	50-324	Front Support	1	28-966	n/a	52-201	Nut $\frac{5}{16}$ "	20
28-966	008	50-344	Vertical Tray Brace	2	28-966	n/a	52-127	Lock Washer	20
28-966	009	50-174	Rim & Tire (Knobby)	2	28-966	n/a	52-670	Cotter Pin	2
28-966	009	84-714	Rim & Tire (Flat Free)	2	28-966	n/a	52-108	Washer $\frac{5}{8}$ " x 1- $\frac{3}{4}$ "	2
28-966	009	80-105	Rim & Tire (Ribbed)	2	28-966	022	50-328	Leg Stabilizer	2
28-966	010	50-326	Nose Piece	1	28-966	n/a	80-102	Innertube	2
					28-966	n/a	80-101	Bearings (pr)	2

Order by Part #

Call 800-444-7060

Bon[®]

Trusted since 1958

4430 Gibsonia Rd. • Gibsonia, PA 15044 • USA • www.bontool.com

PL28966 07/15